



## THE **ALLARD KARIBUS**

(TAX FREE CONVERSIONS ON THE NEW 'THAMES' 15 cwt. VAN)

- SEATING :** 12 seats arranged in accordance with drawing overleaf, including driver and one passenger in the front. The rear seats arranged longitudinally with back squabs and are upholstered in leathercloth in various colours.
- WINDOWS :** Three units on each side in polished metal frames, the rearmost being of the sliding type to provide ventilation.
- INTERIOR :** Interior door handles fitted to all doors.
- FLOOR :** Best quality linoleum.
- STEPS :** Fixed step fitted to nearside front and rear doors. Folding type to side passenger door.

**CONVERSION PRICE : £100 - 0 - 0**

**PLEASE NOTE :** In order to comply with H.M. Customs & Excise regulations, the vehicle to be converted must be the 15 cwt. Van, fitted with the side loading door and front passenger seat.

We will accept the Vans in Primer or painted in the Ford range of colours. Should you require your own colour on the primer Vans, the cost will be extra.

The Company reserves the right to amend or alter the specification of any models without notice.

---

## **ALLARD MOTOR COMPANY LTD.**

Reg. Office and Head Office

Telegrams  
Almotco, London.

**24/28 CLAPHAM HIGH STREET,  
LONDON, S.W.4**

Telephone  
MACaulay 3201/3

**Works :** 53 Clapham Common, Southside, London, S.W.4

MACaulay 5495/7

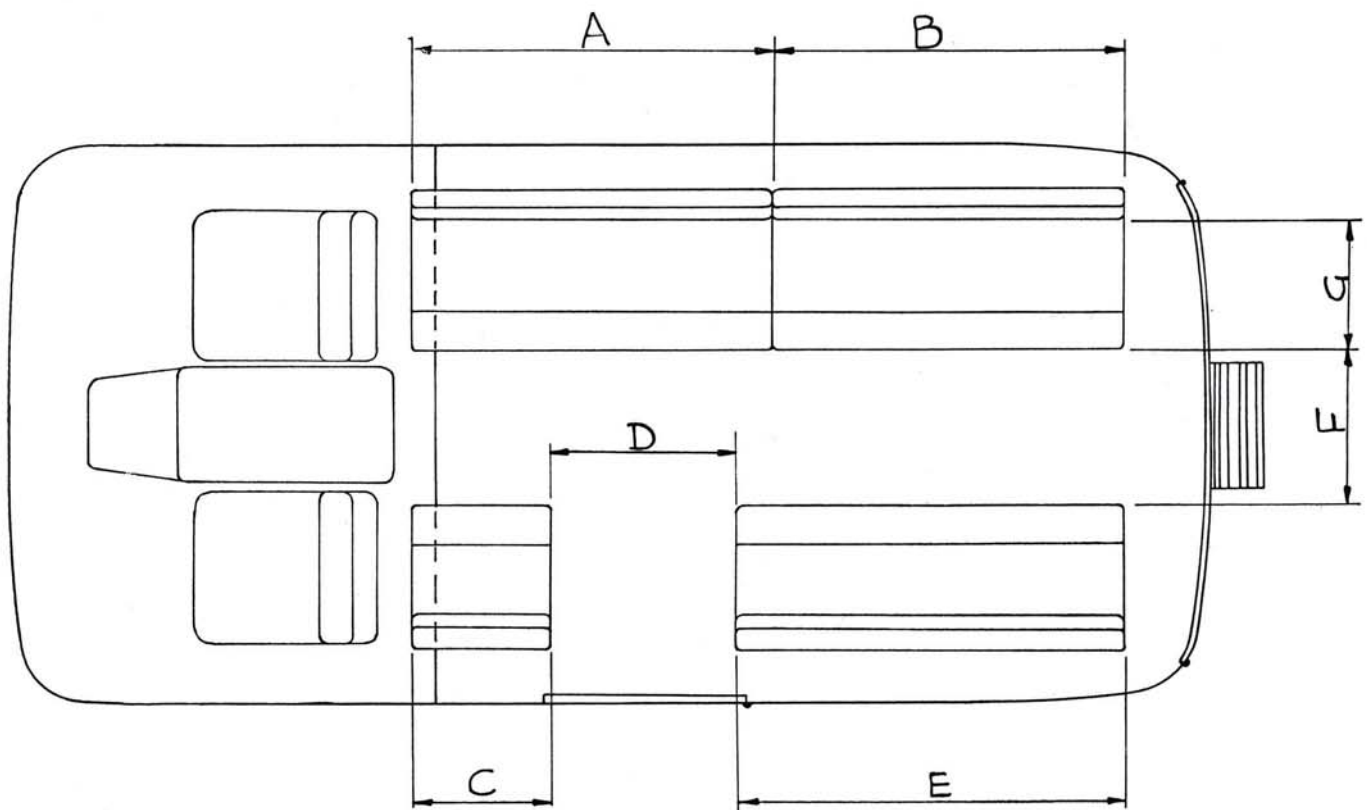

INTERNAL DIMENSIONS

A	B	C	D	E	F	G
48"	48"	16"	23½"	52"	18"	14"